



**Your Wood Door Experts**



Over 30 years, supplying Canada with the timeless appeal of commercial wood doors.



Family Operated,  
Decades of Experience

[VISSEER 2026 Brochure](#)



## Table of Contents



[Company Summary](#)



[Interior Doors](#)



[Door Styles](#)



[Door Materials](#)



[Design & Durability Specifications](#)



[Online Machine Sheet System](#)



[Contact Information](#)

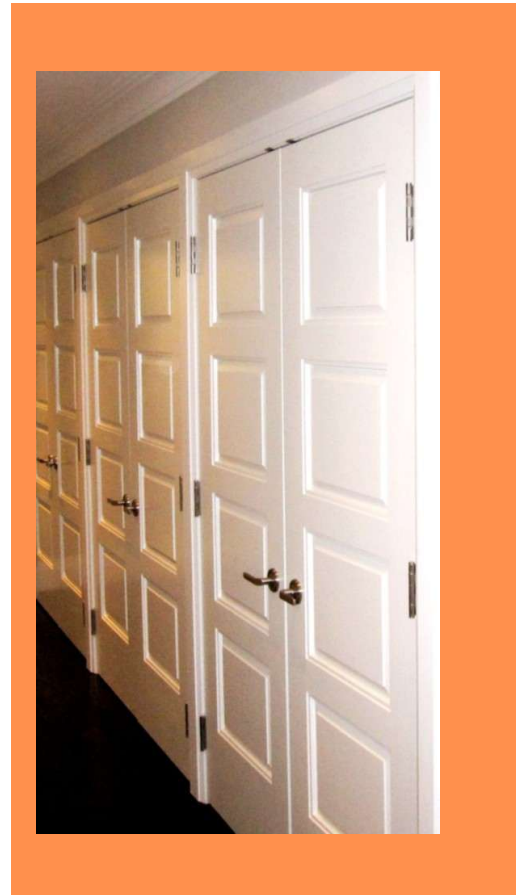

[www.vissermfg.ca](http://www.vissermfg.ca)



 **VISSER**  
MANUFACTURING  
Division of Complete Entry Systems & Services (2004) Inc.

# Company Summary



## VISSER Manufacturing

Visser Manufacturing Ltd. was incorporated in 1992 and has grown steadily throughout the years due in large part to our loyal customers and repeat business. We take pride in the quality of our craft and consider customer satisfaction our top priority. Our dedicated and skilled staff is able to handle varied and complex custom projects. Supplying our products from Southern Ontario to Canada wide.

We manufacture all our products in Ottawa including fire rated wood doors in 20, 45 and 90 minute ratings. We also have the facilities to pre-machine and finish in our shop.

### What we offer:

Design Variety - We offer finishing options for various types of wood, including laminates.

Wood Veneer Finishing - The beauty of wood shines with the dramatic difference of each unique grain.

Quality Materials - Standard Hardboard, Red Oak, Cherry, Mahogany, Maple, Birch, Walnut, and more.

Fire Rated Doors & Frames - Secure peace of mind, keeping people safe and minimize potential property damage.

Installation Guidelines - After sales service is key to our door business.

### Our Doors offer Durability, Function, and Style.

Our commercial doors are built to a higher level of durability in order to withstand heavy traffic and repetitive use. We offer a grand selection of competitively priced doors to choose from. Our specialist craftsmen are dedicated to producing finished pieces which compliment the exceptionalism & success of your professional setting.

[www.vissermfq.ca](http://www.vissermfq.ca)

---



# Interior Doors

Wood doors bring an inviting, serene natural beauty to any professional space. For thousands of years, a timeless choice in sophisticated design.

The craftsmanship, feel, and natural beauty of wood doors makes them stand out from all other types of doors for commercial spaces. Interior wood doors are an essential design element that can provide a natural sense of warmth, well-being & clarity for productive work environments, offering a refined feel and sophisticated aesthetics. Wood has been used with interior doors for generations, due to its long-lasting durability and fully customizable options in design.

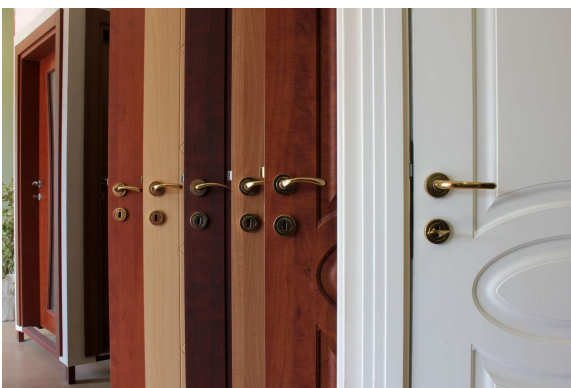

Wood has great insulation properties, and noise is kept out more than with most other types of doors. A wooden door will offer you reliability over its long life, as they are one of the few door materials which can be repaired. As solid wood doors are made from natural materials, they are biodegradable and can be recycled or reused. Also, wood doors can be fire rated to prevent the spread of smoke and fire, providing security and peace of mind.

For commercial spaces, wooden doors offer the best option in practical function combined with versatility in timeless design options.

[www.vissermfg.ca](http://www.vissermfg.ca)

---

# Interior Door Styles

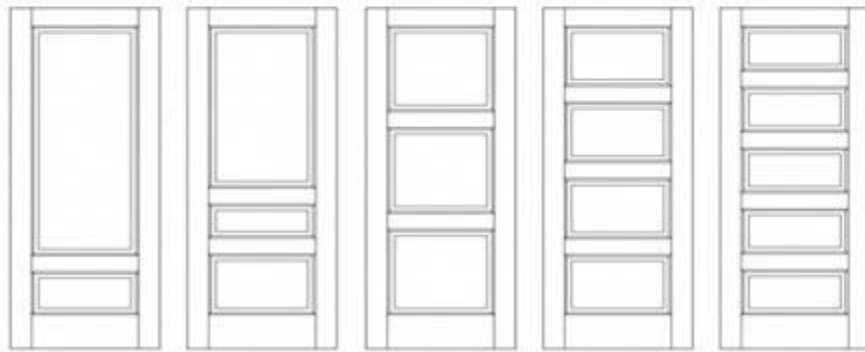
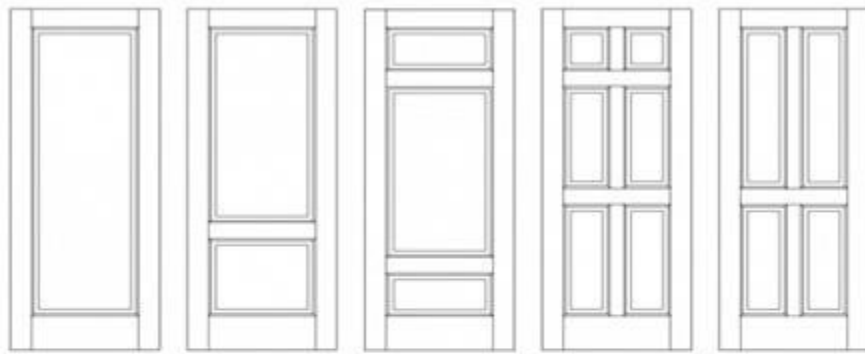

Up to 6x10, Standard Doors, Barn Doors, Dutch Doors, Sliders, C Berkley Lines.

**Full customization available, please contact us.**

[www.vissermfg.ca](http://www.vissermfg.ca)

---

# Wood veneers available



Flat Sliced Red Oak



Rift Red Oak



Cherry



Mahogany



Maple



Walnut



Birch

Please see the next page for plastic laminates, for other veneer options please inquire.

Please note that print does not show exact color.\*

[www.vissermfg.ca](http://www.vissermfg.ca)

---

**ARBORITE BASICS PROGRAM**



S-405 CA  
BLACK



S-431 CA  
WILLOW GREY



S-548 CA  
CUSTOM GREY



S-550 CA  
ELEGANT WHITE



S406 CA  
SILVER GREY



S445 CA  
ALMOND

## ARBORITE BASICS PROGRAM



P885 CA  
BLACK GRIT



P886 CA  
GREY GRIT



W403 CA  
NATURAL ANEGRE



W405 CA  
CHERRY BRANDY



1539 CA  
ARCHITECTURAL MAPLE



W450 CA  
RIFT GOLDEN OAK

# VM COMMERCIAL | STANDARD CORES | ME | BE Interior Doors

COMMERCIAL | INTERIOR STANDARD CORES | ME | BE

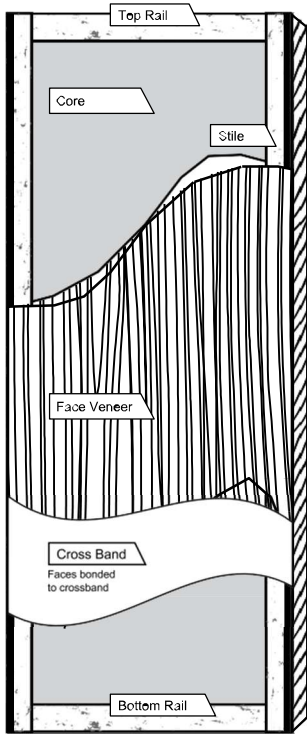

FD 3 - 5 Ply | FD-HPDL 3 - 5 Ply

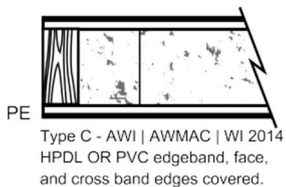
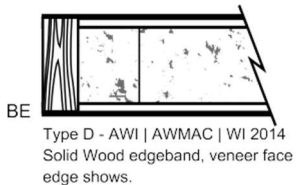
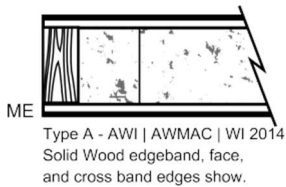

## VM PRODUCT TECHNICAL SPECIFICATIONS

STANDARD CORES   ME   BE	
<b>CORE TYPE</b>	Cores: Solid Wood, SCL, **PC, MDF, Hollow (interior use) Duty Load Options: Light, Medium, Heavy & Lead Lined
<b>COMPLIES WITH INDUSTRY STANDARDS</b>	A.W.I / A.W.M.A.C. SECTION 1300 W.D.M.A. SERIES I.S.1-A CSA 0132.2 SERIES 90
<b>FIRE RATING</b>	<b>NON-RATED</b>  Neutral or Positive (pressure tested and labeled) Positive Pressure: 20   45   90 Minute UBC 7-2-97, UL 10C, ASTM E152, CAN4-S104, NFPA 252 Flat Astragals are allowed on intumescent edge sealed stiles. Metal Edge & Astragals-not allowed on intumescent edge sealed stiles. 90 minute rated doors allow electrical strikes UL 10C positive pressure category A option: (Cat A-1 Additional edge seal is not required between door and frame. A-2 Intumescent is manufactured or incorporated into the door construction or surface). UL 10C positive pressure category B: (Cat B- Doors may require additional edge-sealing system applied frame OR a frame with concealed intumescent).  Neutral Pressure: 20   45   90 Minute UBC 7-2-94, UL 10B, ASTM E152, CAN4-S104, NFPA 252 Metal Edge & Astragals paired on some standard single swing doors UL 10B neutral pressure
<b>DOOR WEIGHT, THICKNESS, &amp; MAXIMUM SIZES</b>	Thickness & Weight: 1-3/8" (35 mm) = 5.2lb/ft <sup>2</sup> Thickness & Weight: 1-3/4" (44 mm) = 6.2lb/ft <sup>2</sup> *PC only-Thickness & Weight: 1-3/8" (35 mm) LD-1 = 4,3lb/ft <sup>2</sup>   LD-2 = 4,7lb/ft <sup>2</sup> *PC only- Thickness & Weight: 1-3/4" (44 mm) LD-1 = 5,2lb/ft <sup>2</sup>   LD-2 = 5,6lb/ft <sup>2</sup> Non-Rated: 48" x 120" (1219 mm x 3048 mm). Positive pressure: 48" x 108" (1219 mm x 2743 mm). Neutral pressure: 48" x 120" (1219 mm x 3048 mm).
<b>STILES</b>	<b>ME</b> (Matching Edge) 7/16" (11 mm) hardwood <b>BE</b> (Blind Edge) 7/16" (11 mm) hardwood Laminated to 1-7/16 (36mm) or 4" (102 mm) SCL <b>PE</b> (Plastic Edge): HPDL edges. *Stile & Rail variations: Solid Wood, SCL, MDF, HDF
<b>RAILS</b>	1-1/2" (38mm) or 3" (76 mm) proprietary material. *Rail & Stile variations: Solid Wood, SCL, MDF, HDF
<b>ADHESIVE</b>	Type II PVA (UF-Free).
<b>FACE</b>	Wood Veneer, HPDL Laminated to a HDF, & Decorative Plastics.
<b>LITE/LOUVER OPENINGS</b>	Cut-out for lite and louver with size limitations. Wood & metal louvers permitted in non-rated doors. Factory glazing recommended. Cut-out can not exceed 40% of door area (LD-1). Minimum 5" (127mm) from stiles or rails Non-Rated Minimum 1-1/2" (38mm) from cutout to cutout.
<b>MACHINING</b>	Cylindrical, Bevel, hinge and lock, mortise lock & exits, card & unit locks, vertical rods, pivot and other hardware preps. Custom available on request. Up to two raceways are allowed - any location in the door, not to exceed a size of 3/8 (10mm) x 3/8" (10mm).
<b>SURFACE HARDWARE INSTALLATION REGULATIONS</b>	Hardware installation in accordance NFPA 80, 2007 edition, section 4.1.3. Surface hardware can only be applied to surface by drilling function holes. Function Holes can not exceed 1" (25mm) with the exception of cylinders. Undercutting is permitted up to 3/4" (19mm) max. Protection plates are permitted.
<b>FACTORY FINISH</b>	Solid Wood & Wood Veneers: Clear Finish, Stain & Lacquer Finish, & Custom Stain Colours Available. Standard sealing top and bottom. Paint Grade Doors: HDF   Birch   Primed or Painted.
<b>NOTES</b>	

Doors:reDefined

\*\* PC=Particleboard LD-1 or LD-2 | Density 28-32 PCF (449-513 kg/m<sup>3</sup>)  
\* FPCM: Fire Proof Composite Material  
\*Stile & Rail variations are decided by the manufacturer per door core type.

Project:	
Contractor:	Date:

NON RATED



# VM COMMERCIAL | STANDARD CORES | ME | BE Interior Doors (LSL - LAMINATED STRAND LUMBER)

LSL - LAMINATED STRAND LUMBER  
(Structural Composite Lumber)

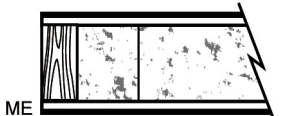
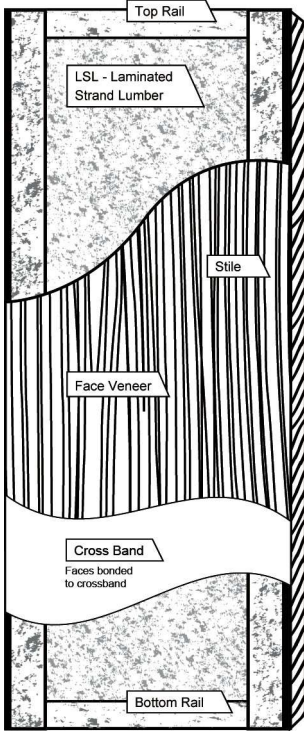

ME  
Type A - AWI | AWMAC | WI 2014  
Solid Wood edgeband, face, and cross band edges show.

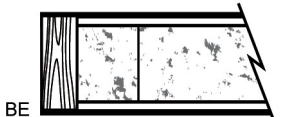

BE  
Type D - AWI | AWMAC | WI 2014  
Solid Wood edgeband, veneer face edge shows.

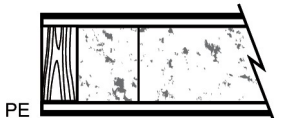

PE  
Type C - AWI | AWMAC | WI 2014  
HPDL OR PVC edgeband, face, and cross band edges covered.



## VM PRODUCT TECHNICAL SPECIFICATIONS

STANDARD CORES   ME   BE	
<b>CORE TYPE</b>	Cores: Solid Wood, SCL, **PC, MDF, Hollow (interior use) Duty Load Options: Light, Medium, Heavy, & Lead Lined
<b>COMPLIES WITH INDUSTRY STANDARDS</b>	A.W.I / A.W.M.A.C. SECTION 1300 W.D.M.A. SERIES I.S.1-A CSA 0132.2 SERIES 90
<b>FIRE RATING</b>	<b>NON-RATED</b>  Neutral or Positive (pressure tested and labeled) Positive Pressure: 20   45   90 Minute UBC 7-2-97, UL 10C, ASTM E152, CAN4-S104, NFPA 252 Flat Astragals are allowed on intumescent edge sealed stiles. Metal Edge & Astragals-not allowed on intumescent edge sealed stiles. 90 minute rated doors allow electrical strikes UL 10C positive pressure category A option: (Cat A-1 Additional edge seal is not required between door and frame. A-2 Intumescent is manufactured or incorporated into the door construction or surface). UL 10C positive pressure category B: (Cat B- Doors may require additional edge-sealing system applied frame OR a frame with concealed intumescent).  Neutral Pressure: 20   45   90 Minute UBC 7-2-94, UL 10B, ASTM E152, CAN4-S104, NFPA 252 Metal Edge & Astragals paired on some standard single swing doors UL 10B neutral pressure
<b>DOOR WEIGHT, THICKNESS, &amp; MAXIMUM SIZES</b>	Thickness & Weight: 1-3/8" (35 mm) = 5.2lb/ft <sup>2</sup> Thickness & Weight: 1-3/4" (44 mm) = 6.2lb/ft <sup>2</sup> *PC only-Thickness & Weight: 1-3/8" (35 mm) LD-1 = 4,3lb/ft <sup>2</sup>   LD-2 = 4,7lb/ft <sup>2</sup> *PC only- Thickness & Weight: 1-3/4" (44 mm) LD-1 = 5,2lb/ft <sup>2</sup>   LD-2 = 5,6lb/ft <sup>2</sup> Non-Rated: 48" x 120" (1219 mm x 3048 mm). Positive pressure: 48" x 108" (1219 mm x 2743 mm). Neutral pressure: 48" x 120" (1219 mm x 3048 mm).
<b>STILES</b>	<b>ME</b> (Matching Edge) 7/16" (11 mm) hardwood <b>BE</b> (Blind Edge) 7/16" (11 mm) hardwood Laminated to 1-7/16 (36mm) or 4" (102 mm) SCL <b>PE</b> (Plastic Edge): HPDL edges. *Stile & Rail variations: Solid Wood, SCL, MDF, HDF
<b>RAILS</b>	1-1/2" (38mm) or 3" (76 mm) *Rail & Stile variations: Solid Wood, SCL, MDF, HDF
<b>ADHESIVE</b>	Type II PVA (UF-Free).
<b>FACE</b>	Wood Veneer, HPDL Laminated to a HDF, & Decorative Plastics.
<b>LITE/LOUVER OPENINGS</b>	Cut-out for lite and louver with size limitations. Wood & metal louvers permitted in non-rated doors. Factory glazing recommended. Cut-out can not exceed 40% of door area (LD-1). Minimum 5" (127mm) from stiles or rails Non-Rated Minimum 1-1/2" (38mm) from cutout to cutout.
<b>MACHINING</b>	Cylindrical, Bevel, hinge and lock, mortise lock & exits, card & unit locks, vertical rods, pivot and other hardware preps. Custom available on request. Up to two raceways are allowed - any location in the door, not to exceed a size of 3/8" (10mm) x 3/8" (10mm).
<b>SURFACE HARDWARE INSTALLATION REGULATIONS</b>	Hardware installation in accordance NFPA 80, 2007 edition, section 4.1.3. Surface hardware can only be applied to surface by drilling function holes. Function Holes can not exceed 1" (25mm) with the exception of cylinders. Undercutting is permitted up to 3/4" (19mm) max. Protection plates are permitted.
<b>FACTORY FINISH</b>	Solid Wood & Wood Veneers: Clear Finish, Stain & Lacquer Finish, & Custom Stain Colours Available. Standard sealing top and bottom. Paint Grade Doors: HDF   Birch   Primed or Painted.
<b>NOTES</b>	

Doors-reDefined

\*\* PC=Particleboard LD-1 or LD-2 | Density 28-32 PCF (449-513 kg/m<sup>3</sup>)  
\* FPCM: Fire Proof Composite Material  
\*Stile & Rail variations are decided by the manufacturer per door core type.

Project:	
Contractor:	Date:

# VM COMMERCIAL | FR SOLID CORES | M E

## Interior Door Fire Rated Cores

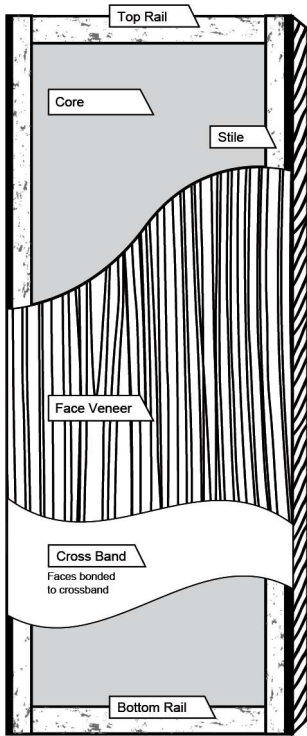

FD 3 - 5 Ply | FD-HPDL 3 - 5 Ply

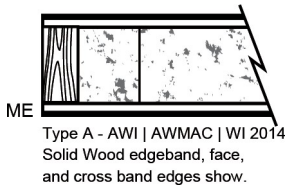

ME  
Type A - AWI | AWMAC | WI 2014  
Solid Wood edgeband, face, and cross band edges show.

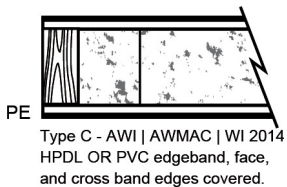

PE  
Type C - AWI | AWMAC | WI 2014  
HPDL OR PVC edgeband, face, and cross band edges covered.



### VM PRODUCT TECHNICAL SPECIFICATIONS

SOLID CORES FIRE RATED   ME	
<b>CORE TYPE</b>	Duty Load Options: Medium, Heavy, & Lead Lined
<b>COMPLIES WITH INDUSTRY STANDARDS</b>	A.W.I / A.W.M.A.C. SECTION 1300 W.D.M.A. SERIES I.S.1-A CSA 0132.2 SERIES 90
<b>FIRE RATING</b>	Neutral or Positive (pressure tested and labeled)  Palusol® & BASF fire seals  Positive or Neutral Pressure: *Surface mounted edge guards allowed on non-intumescent stiles. *no additional edge sealing required for vertical rods with 5" (127mm) metal channels. *Some fire door constructions may use *FMCP stiles & rails.  Positive Pressure: 20   45   90 Minute UBC 7-2-97, UL 10C, ASTM E152, CAN4-S104, NFPA 252 Flat Astragals are allowed on intumescent edge sealed stiles. Metal Edge & Astragals-not allowed on intumescent edge sealed stiles. 90 minute rated doors allow electrical strikes UL 10C positive pressure category A option: (Cat A-1 Additional edge seal is not required between door and frame. A-2 Intumescent is manufactured or incorporated into the door construction or surface). UL 10C positive pressure category B: (Cat B- Doors may require additional edge-sealing system applied frame OR a frame with concealed intumescent).  Neutral Pressure: 20   45   90 Minute UBC 7-2-94, UL 10B, ASTM E152, CAN4-S104, NFPA 252 Metal Edge & Astragals paired on some standard single swing doors UL 10B neutral pressure
<b>DOOR WEIGHT, THICKNESS, &amp; MAXIMUM SIZES</b>	Thickness & Weight: 1-3/8" (35 mm) = Thickness & Weight: 1-3/4" (44 mm) = *PC only-Thickness & Weight: 1-3/8" (35 mm) LD-1 = 4,3lb/ft <sup>2</sup>   LD-2 = 4,7lb/ft <sup>2</sup> *PC only- Thickness & Weight: 1-3/4" (44 mm) LD-1 = 5,2lb/ft <sup>2</sup>   LD-2 = 5,6lb/ft <sup>2</sup> Non-Rated: 48" x 120" (1219 mm x 3048 mm). Positive pressure: 48" x 108" (1219 mm x 2743 mm). Neutral pressure: 48" x 120" (1219 mm x 3048 mm).
<b>STILES</b>	<b>ME</b> (Matching Edge) 7/16" (11 mm) proprietary material (FPCM)*. Laminated to 1" (25 mm) proprietary material (FPCM)*.  <b>PE</b> (Plastic Edge): HPDL edges.
<b>RAILS</b>	
<b>ADHESIVE</b>	Type II PVA (UF-Free).
<b>FACE</b>	Wood Veneer, HPDL Laminated to a HDF, & Decorative Plastics.
<b>LITE/LOUVER OPENINGS</b>	Cut-out for lite and louver with size limitations. Louvers contain industry standard fire dampers. Positive Pressure (Cat. A) Doors eligible for "S" (Smoke & Draft Control Assemblies with (Cat. H ) Gasket.
<b>MACHINING</b>	Cylindrical, Bevel, hinge and lock, mortise lock & exits, card & unit locks, vertical rods, pivot and other hardware preps. Custom available on request. Up to two raceways are allowed - any location in the door, not to exceed a size of 3/8" (10mm) x 3/8" (10mm).
<b>SURFACE HARDWARE INSTALLATION REGULATIONS</b>	Hardware installation in accordance NFPA 80, 2007 edition, section 4.1.3. Surface hardware can only be applied to surface by drilling function holes. Function Holes can not exceed 1" (25mm) with the exception of cylinders. Undercutting is permitted up to 3/4" (19mm) max. Protection plates are permitted.
<b>FACTORY FINISH</b>	Solid Wood & Wood Veneers: Clear Finish, Stain & Lacquer Finish, & Custom Stain Colours Available. Standard sealing top and bottom. Paint Grade Doors: HDF   Birch   Primed or Painted.
<b>NOTES</b>	

Doors:reDefined

\*\* PC=Particleboard LD-1 or LD-2 | Density 28-32 PCF (449-513 kg/m<sup>3</sup>)  
\* FPCM: Fire Proof Composite Material

Project:	
Contractor:	Date:

# VM COMMERCIAL | FR SOLID CORES | M E

## Interior Door Fire Rated Cores - FR 45 Minute

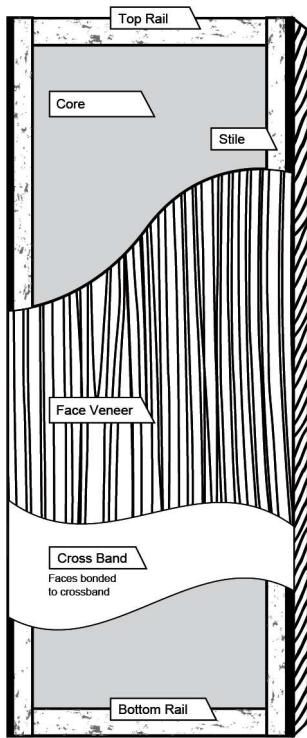

FD 3 - 5 Ply | FD-HPDL 3 - 5 Ply

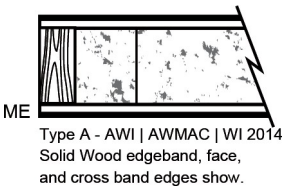

ME  
Type A - AWI | AWMAC | WI 2014  
Solid Wood edgeband, face,  
and cross band edges show.

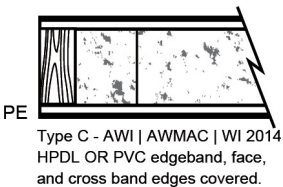

PE  
Type C - AWI | AWMAC | WI 2014  
HPDL OR PVC edgeband, face,  
and cross band edges covered.

VM PRODUCT TECHNICAL SPECIFICATIONS	
	<b>SOLID CORES FR 45   ME</b>
<b>CORE TYPE</b>	Fire Rated Solid Cores (interior use) Duty Load Options: Medium, Heavy, & Lead Lined
<b>COMPLIES WITH INDUSTRY STANDARDS</b>	A.W.I / A.W.M.A.C. SECTION 1300 W.D.M.A. SERIES I.S.1-A CSA 0132.2 SERIES 90
<b>FIRE RATING</b>	<b>45 Minute</b> Neutral or Positive (pressure tested and labeled)
Palusol® & BASF fire seals	Positive Pressure: 20   45   90 Minute UBC 7-2-97, UL 10C, ASTM E152, CAN4-S104, NFPA 252 Flat Astragals are allowed on intumescent edge sealed stiles. Metal Edge & Astragals-not allowed on intumescent edge sealed stiles. 90 minute rated doors allow electrical strikes
Positive or Neutral Pressure: *Surface mounted edge guards allowed on non-intumescent stiles. *no additional edge sealing required for vertical rods with 5" (127mm) metal channels. *Some fire door constructions may use *FMCP stiles & rails.	UL 10C positive pressure category A option: (Cat A-1 Additional edge seal is not required between door and frame. A-2 Intumescent is manufactured or incorporated into the door construction or surface). UL 10C positive pressure category B: (Cat B- Doors may require additional edge-sealing system applied frame OR a frame with concealed intumescent).
	Neutral Pressure: 20   45   90 Minute UBC 7-2-94, UL 10B, ASTM E152, CAN4-S104, NFPA 252 Metal Edge & Astragals paired on some standard single swing doors UL 10B neutral pressure
<b>DOOR WEIGHT, THICKNESS, &amp; MAXIMUM SIZES</b>	Thickness & Weight: 1-3/8" (35 mm) = 5.2lb/ft <sup>2</sup> Thickness & Weight: 1-3/4" (44 mm) = 6.2lb/ft <sup>2</sup> *PC only-Thickness & Weight: 1-3/8" (35 mm) LD-1 = 4.3lb/ft <sup>2</sup>   LD-2 = 4.7lb/ft <sup>2</sup> *PC only- Thickness & Weight: 1-3/4" (44 mm) LD-1 = 5.2lb/ft <sup>2</sup>   LD-2 = 5.6lb/ft <sup>2</sup> Non-Rated: 48" x 120" (1219 mm x 3048 mm). Positive pressure: 48" x 108" (1219 mm x 2743 mm). Neutral pressure: 48" x 120" (1219 mm x 3048 mm).
<b>STILES</b>	<b>ME</b> (Matching Edge): 7/16" (11 mm) proprietary material (FPCM)*. Laminated to 1" (25 mm) proprietary material (FPCM)*. <b>PE</b> (Plastic Edge): HPDL edges.
*Stile and rail dimensions are approximate sizes prior to trimming and can vary due to prefit requirements.	
<b>RAILS</b>	1-1/2" (38 mm) proprietary material (FPCM)*.
<b>ADHESIVE</b>	Type II PVA (UF-Free).
<b>FACE</b>	Wood Veneer, HPDL Laminated to a HDF, & Decorative Plastics.
<b>LITE/LOUVER OPENINGS</b>	Cut-out for lite and louver with size limitations. Louvers contain industry standard fire dampers. Positive Pressure (Cat. A) Doors eligible for "S" (Smoke & Draft Control Assemblies with (Cat. H) Gasket.
<b>MACHINING</b>	Cylindrical, Bevel, hinge and lock, mortise lock & exits, card & unit locks, vertical rods, pivot and other hardware preps. Custom available on request. Up to two raceways are allowed - any location in the door, not to exceed a size of 3/8" (10mm) x 3/8" (10mm).
<b>SURFACE HARDWARE INSTALLATION REGULATIONS</b>	Hardware installation in accordance NFPA 80, 2007 edition, section 4.1.3. Surface hardware can only be applied to surface by drilling function holes. Function Holes can not exceed 1" (25mm) with the exception of cylinders. Undercutting is permitted up to 3/4" (19mm) max. Protection plates are permitted.
<b>FACTORY FINISH</b>	Solid Wood & Wood Veneers: Clear Finish, Stain & Lacquer Finish, & Custom Stain Colours Available. Standard sealing top and bottom. Paint Grade Doors: HDF   Birch   Primed or Painted.
<b>NOTES</b>	
<b>Doors.reDefined</b>	

\*\* PC=Particleboard LD-1 or LD-2 | Density 28-32 PCF (449-513 kg/m<sup>3</sup>)  
\* FPCM: Fire Proof Composite Material

Project:	
Contractor:	Date:



# Online Ordering Machine Sheet

<b>FACE TYPE</b> Paint Grade	<b>Left Hand</b> 1	<b>Right Hand</b> 3	<b>Hardware Details</b>
<b>FINISHED SIZE</b> <small>(width x height)</small> 35 13/16" x 83 1/8" BEVELLED	<p>23 1/8" from TOP Dia: 9/16" O</p> <p>7 3/8"</p> <p>39 5/16"</p> <p>71 1/4"</p> <p>From TOP of Door 43 9/16"</p>		
<b>TYPE</b> 1 3/4" - Solid Core			
<b>HINGES</b> Height: 4 1/2" Standard Weight (0.134")			
<b>LOCKSET</b> Model: Standard 161 Latch: 1 1/8" x 2 1/4" Backset: 2 3/4" Face Bore: 2 1/8"			
<b>FINISHING</b> NO FINISHING			

Please Note: Door Drawing is not to scale and is a simplified representation of the machining added to the door(s).

 <p><b>VISSEER</b> MANUFACTURING <small>Division of Complete Entry Systems &amp; Services (2004) Inc. 2870 Sheffield Road, Ottawa, ON, K1B 3V9 613-822-7868   1-877-822-7869   vissermfg.ca</small></p>	Company: <b>Visser Order</b> Approved By: John Smith	PO: Purchase Order	PL #: Date: 05/19/2026 02:14 PM	Page #: 1
--	---	-----------------------	---------------------------------------	--------------

[www.vissermfg.ca](http://www.vissermfg.ca)

Main Office Number:

613 - 822 - 7868

Main Office Email:

**sales@vissermfg.ca**

